

Miniroller

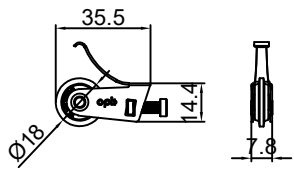

Guiding part/Führung

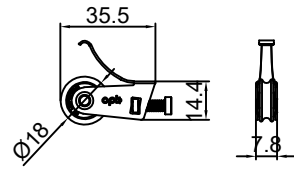

Running part/Laufwerk

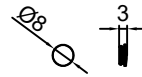

Cover cap/Abdeckkappe

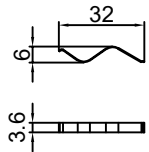

Stopper/Stopper

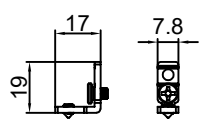

Frame connection
/Rahmenverbindung
(with vertical frame)

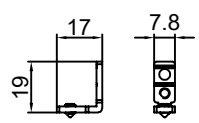

Frame connection
/Rahmenverbindung
(without vertical frame)

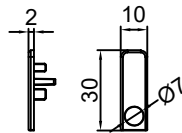

End cap/Endkappe

Cabinet door width calculation /Schrank Türbreitenberechnung
_with vertical frame

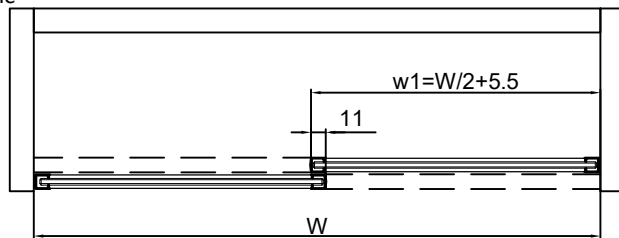

Cabinet door width calculation /Schrank Türbreitenberechnung
_without vertical frame

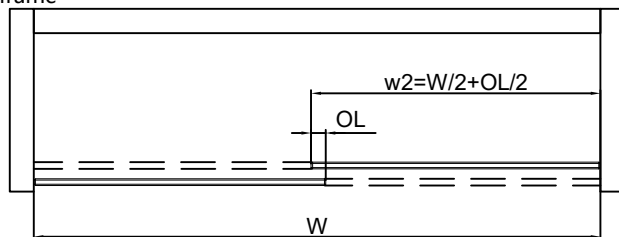

Track profile/Schienen

Guiding track and running track installation type

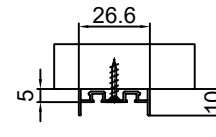

Installation with screw

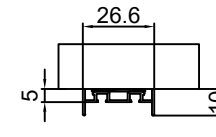

Installation with
double-side tape

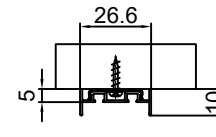

Installation with clasp for
track

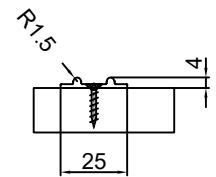

Installation with screw

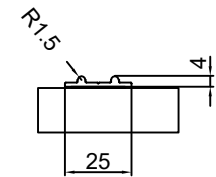

Installation with double-side tape

Tracks/Schienen

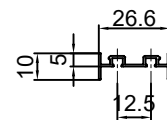

Guiding track double
/Führungsschiene doppel

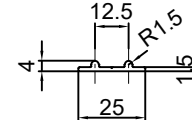

Running track double
/Laufschiene,doppel

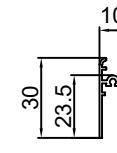

Horizontal frame
/Horizontales Rahmenprofil

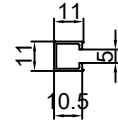

Vertical frame
/Vertikales
Rahmenprofil

<p>OPK Europe GmbH Jungbansstraße 16 72160 Horb am Neckar</p>	Miniroller	Name: Miniroller
	Creator: LXP	Ratio/Verhältnis: 1:2
	Description: Application for single and double glass sliding door. Door panel installation height is adjustable.	Format: A3
	Date/Datum: 24/05/19	Page / Seite: 1/2
We reserve the right to make changes. No responsibility is accepted.		